

DOOR SCHEDULE

DOOR TYPES (NO SCALE)

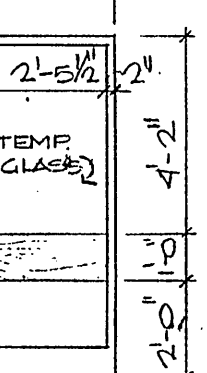

NO	LOCATION	SIZE	TYPE	MAT	FIN	TYPE	MAT	FIN	HD	JM	SILL	GL	RATING	HARDWARE	THRESH	REMARKS
E1	EXT. AUTO LAB 101	3' x 7' x 134"	A	SCWD	S+V	1	HM	PT	1	AIS	2	AIS	3	AIS		UNITIZED FRAME (UP) (11)
E2	CH. AUTO LAB 101	12' x 12' x 2"	E	INSUL. WOOD	PT	MFG	STEEL	MFG	3	AIS	0	AIS	0	AIS		WEATHERSTRIP
E3	EXT. CLASS 102	3' x 7' x 134"	A	SCWD	S+V	1	HM	PT	1	AIS	2	AIS	3	AIS		UF
E4	EXT. CLASS 103	3' x 7' x 134"	A	SCWD	S+V	1	HM	PT	1	AIS	2	AIS	3	AIS		UF
E5	CH. VELD. LAB 107	12' x 11' x 2"	E	INSUL. WOOD	PT	MFG	STEEL	MFG	3	AIS	0	AIS	0	AIS		WEATHERSTRIP
E6	EXT. VELD. LAB 107	3' x 7' x 134"	A	SCWD	S+V	1	HM	PT	1	AIS	2	AIS	3	AIS		UF
E7	PLUMB/HIG LAB 223	10' x 10' x 2"	D	INSUL. WOOD	PT	MFG	STEEL	MFG	3	AIS	0	AIS	0	AIS		WEATHERSTRIP
E8	PLUMB/HIG LAB 223	3' x 7' x 134"	A	SCWD	S+V	3	HM	PT	1	AIS	2	AIS	3	AIS		UF
E9	CLASS RM 223	3' x 7' x 134"	A	SCWD	S+V	3	HM	PT	1	AIS	2	AIS	3	AIS		UF
E10	CORRIDOR 234	3' x 7' x 134"	A	SCWD	S+V	7	HM	PT	1	AIS	2	AIS	3	AIS		UF
E11	CORRIDOR 235	3' x 7' x 134"	A	SCWD	S+V	8	HM	PT	1	AIS	2	AIS	3	AIS		UF
E12	STAIR 214	3' x 7' x 134"	A	SCWD	S+V	3	HM	PT	1	AIS	2	AIS	3	AIS		UF
E13	CORRIDOR 235	3' x 7' x 134"	A	SCWD	S+V	8	HM	PT	1	AIS	2	AIS	3	AIS		UF
E14	NEW CLASS C6	3' x 7' x 134"	A	SCWD	S+V	2	HM	PT	1	AIS	2	AIS	3	AIS		UF
E15	NEW CLASS C5	3' x 7' x 134"	A	SCWD	S+V	2	HM	PT	1	AIS	2	AIS	3	AIS		UF
E16	CH. DIESEL LAB 122	12' x 14' x 2"	E	INSUL. WOOD	PT	MFG	STEEL	MFG	3	AIS	0	AIS	0	AIS		WEATHERSTRIP
E17	DIESEL LAB 122	3' x 7' x 134"	A	SCWD	S+V	1	HM	PT	1	AIS	2	AIS	3	AIS		UF
E18	CLASS 120	3' x 7' x 134"	A	SCWD	S+V	1	HM	PT	1	AIS	2	AIS	3	AIS		UF
E19	CLASS 111	3' x 7' x 134"	A	SCWD	S+V	1	HM	PT	1	AIS	2	AIS	3	AIS		UF
E20	AUTO LAB 101	3' x 7' x 134"	A	SCWD	S+V	1	HM	PT	1	AIS	2	AIS	3	AIS		UF
E21	AUTO LAB 101	12' x 12' x 2"	E	INSUL. WOOD	PT	MFG	STEEL	MFG	3	AIS	0	AIS	0	AIS		WEATHERSTRIP
1	CLASS 102	3' x 7' x 134"	A	SCWD	S+V	2	HM	PT	1	AIS	2	AIS	3	AIS		UF, RAIL LAB SIDE
2	CLASS 103	3' x 7' x 134"	A	SCWD	S+V	1	HM	PT	1	AIS	2	AIS	3	AIS		UF, RAIL LAB SIDE
3	OFFICE 104	3' x 7' x 134"	A	SCWD	S+V	2	HM	PT	1	AIS	2	AIS	3	AIS		UF, RAIL LAB SIDE
4	OFFICE 104	3' x 7' x 134"	A	SCWD	S+V	2	HM	PT	1	AIS	2	AIS	3	AIS		UF, RAIL LAB SIDE
5	STORAGE 105	3' x 7' x 134"	A	SCWD	S+V	1	HM	PT	1	AIS	2	AIS	3	AIS		UF, RAIL LAB SIDE
6	STORAGE 105	3' x 7' x 134"	A	SCWD	S+V	1	HM	PT	1	AIS	2	AIS	3	AIS		UF, RAIL LAB SIDE
7	STORAGE 110	3' x 7' x 134"	A	SCWD	S+V	1	HM	PT	1	AIS	2	AIS	3	AIS		UF, RAIL LAB SIDE
8	CLASS 111	3' x 7' x 134"	A	SCWD	S+V	2	HM	PT	1	AIS	2	AIS	3	AIS		UF, RAIL LAB SIDE
9	OFFICE 112	3' x 7' x 134"	A	SCWD	S+V	2	HM	PT	1	AIS	2	AIS	3	AIS		UF, RAIL LAB SIDE
10	CLEAN ROOM 118	2' x 7' x 134"	A	SCWD	S+V	1	HM	PT	1	AIS	2	AIS	3	AIS		UF, RAIL LAB SIDE
11	CLEAN ROOM 118	10' x 12' x 2"	D	FIBERGLASS	PT	MFG	STEEL	MFG	3	AIS	0	AIS	0	AIS		NORMAL HORM TRACK
12	MACHINEROM 119	3' x 7' x 134"	B	HM	PT	1	HM	PT	1	AIS	2	AIS	3	AIS		UF, RAIL LAB SIDE
13	CORRIDOR 113	3' x 7' x 134"	A	HM	PT	2	HM	PT	1	AIS	2	AIS	3	AIS		UF, RAIL LAB SIDE
14	WOMEN 109	3' x 7' x 134"	A	SCWD	S+V	1	HM	PT	1	AIS	2	AIS	3	AIS		UF, RAIL LAB SIDE
15	VELD. LAB 107	3' x 7' x 134"	A	HM	PT	6	HM	PT	1	AIS	2	AIS	3	AIS		UF, RAIL LAB SIDE
16	CORRIDOR 113	3' x 7' x 134"	A	HM	PT	2	HM	PT	1	AIS	2	AIS	3	AIS		UF, RAIL LAB SIDE
17	STAIR 114	3' x 7' x 134"	A	HM	PT	1	HM	PT	1	AIS	2	AIS	3	AIS		UF, RAIL LAB SIDE
18	ELEVATOR		MFG	HM	PT	SEE ELEV. DETS.	DWG. N									
19	ELEV. EQUIP 116	3' x 7' x 134"	A	HM	PT	1	HM	PT	1	AIS	2	AIS	3	AIS		UF, RAIL LAB SIDE
20	TOOLS 117	3' x 7' x 134"	A	SCWD	S+V	1	HM	PT	1	AIS	2	AIS	3	AIS		UF, RAIL LAB SIDE
21	CLASS 120	3' x 7' x 134"	A	SCWD	S+V	2	HM	PT	1	AIS	2	AIS	3	AIS		UF, RAIL LAB SIDE
22	OFFICE 121	3' x 7' x 134"	A	SCWD	S+V	2	HM	PT	1	AIS	2	AIS	3	AIS		UF, RAIL LAB SIDE
23	CLEAN ROOM 118	12' x 12' x 2"	E	FIBERGLASS	PT	MFG	STEEL	MFG	3	AIS	0	AIS	0	AIS		NORMAL HORM TRACK
24	MACHINEROM 119	3' x 7' x 134"	A	SCWD	S+V	2	HM	PT	1	AIS	2	AIS	3	AIS		UF, RAIL LAB SIDE
A1*	NEW CAB. SDR. C3	2' x 10' x 7' x 134"	G	HM	PT	1	HM	PT	1	AIS	2	AIS	3	AIS		*ADDITIVE ALT. #5
A2*	NEW CLASS RM C4	3' x 7' x 134"	B	HM	PT	1	HM	PT	1	AIS	2	AIS	3	AIS		*ADDITIVE ALT. #5
A3*	NEW CLASS RM C5	3' x 7' x 134"	A	HM	PT	1	HM	PT	1	AIS	2	AIS	3	AIS		*ADDITIVE ALT. #5
35	EQUIP. SDR 223	2' x 7' x 134"	G	SCWD	S+V	3	HM	PT	1	AIS	2	AIS	3	AIS		UF, RAIL LAB SIDE
36	OFFICE 226	3' x 7' x 134"	A	SCWD	S+V	4	HM	PT	1	AIS	2	AIS	3	AIS		UF, RAIL LAB SIDE
37	STORAGE 225	3' x 7' x 134"	A	SCWD	S+V	3	HM	PT	1	AIS	2	AIS	3	AIS		UF, RAIL LAB SIDE
38	TOILET 227	3' x 7' x 134"	C	SCWD	S+V	3	HM	PT	1	AIS	2	AIS	3	AIS		UF, RAIL LAB SIDE
39	CORRIDOR 230	3' x 7' x 134"	A	HM	PT	4	HM	PT	1	AIS	2	AIS	3	AIS		UF, RAIL LAB SIDE
40	CLASS 223	3' x 7' x 134"	A	SCWD	S+V	4	HM	PT	1	AIS	2	AIS	3	AIS		UF, RAIL LAB SIDE
41	MECH. RM 233	2' x 7' x 134"	G	HM	PT	1	HM	PT	1	AIS	2	AIS	3	AIS		UF, RAIL LAB SIDE
42	EXISTING HM PRS															
43																
44																
45																
46																

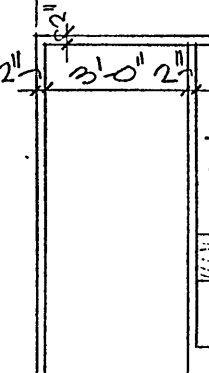
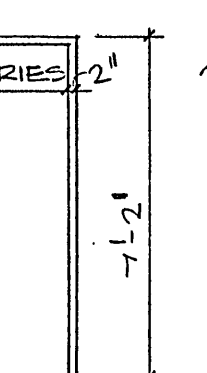
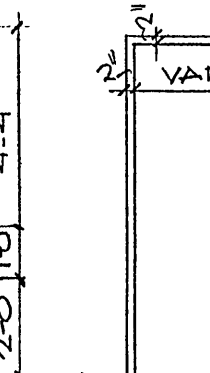
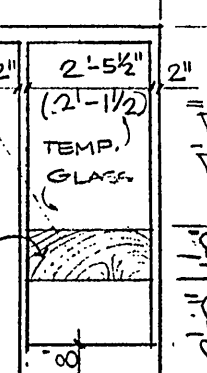
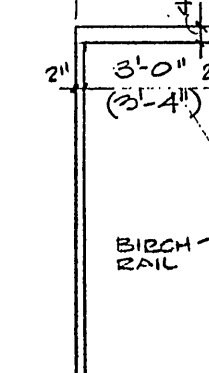
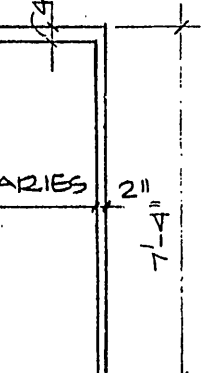
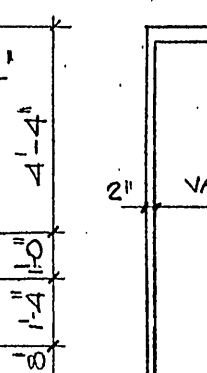
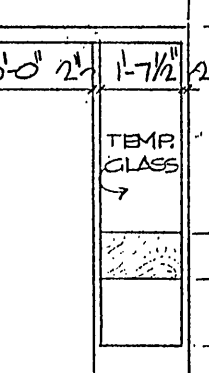
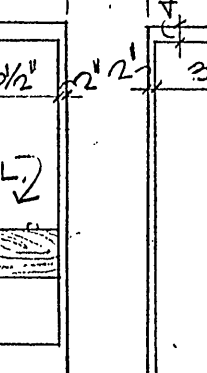
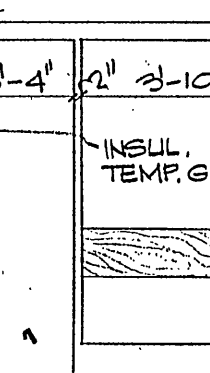
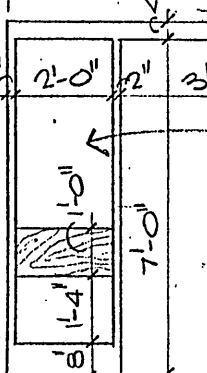
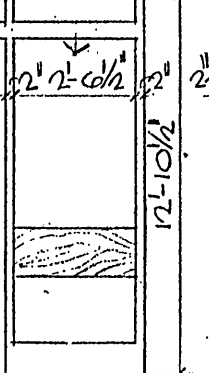
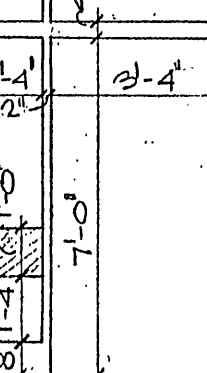
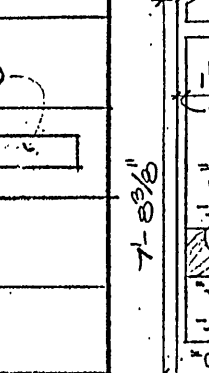
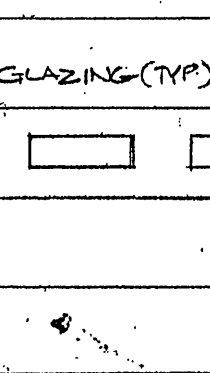
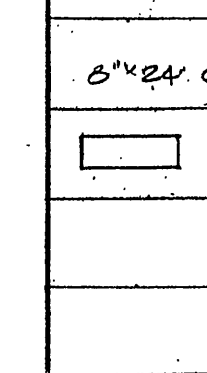
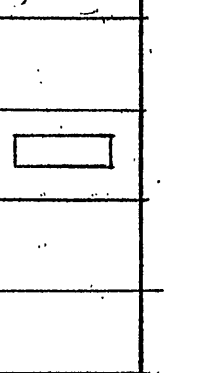
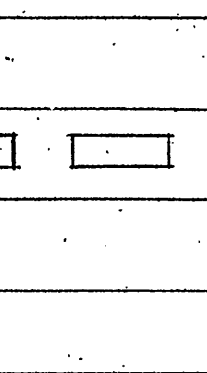
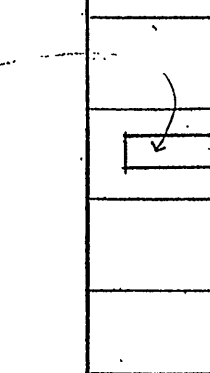
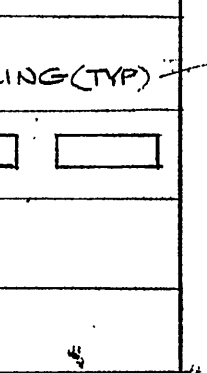
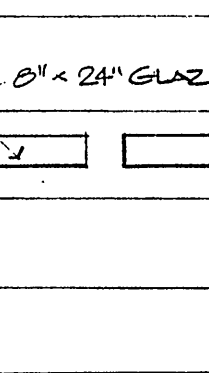
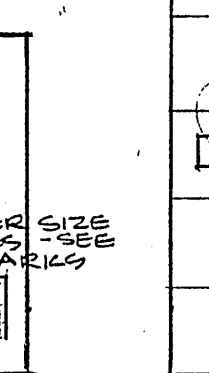
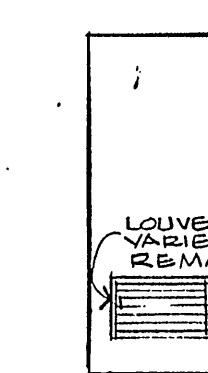
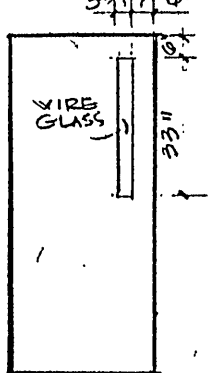
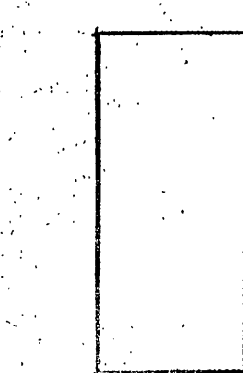